

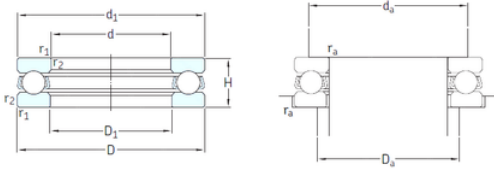

# NTNY BEARING LTD

## skf 51104 bearing

Bearing No. 51104



51104 Bearing 2D drawings and 3D CAD models

Size	20x35x10 mm
Bore Diameter	20 mm
Outer Diameter	35 mm
Width	10 mm
d	20 mm
D	35 mm
H	10 mm
d1	35 mm
r1 min.	0,3 mm
r2 min.	0,3 mm
D1	21 mm
da min.	29 mm
Da max.	26 mm
ra max.	0,3 mm
Weight	0,037 Kg
Basic dynamic load rating (C)	15,1 kN
Basic static load rating (C0)	29 kN
Fatigue load limit (Pu)	1,08
Reference speed	7500 r/min
Limiting speed	10000 r/min
Category	Thrust Ball Bearing
Inventory	6.0
Manufacturer Name	SKF
Minimum Buy Quantity	N/A
Weight / Kilogram	0.043
EAN	7316577058652



## NTNY BEARING LTD

Product Group	B00308
Rolling Element	Ball Bearing
Thrust Bearing	Yes
Single or Double Direction	Single Direction
Banded	No
Cage Material	Steel
Precision Class	ABEC 1   ISO P0
Component Description	Roller Assembly Plus Raceways
Other Features	Single Row
Long Description	20MM Bore 1; 21MM Bore 2; 35MM Outside Diameter; 10MM Height; Ball Bearing; Single Direction; Not Banded; Steel Cage; ABEC 1   ISO P0 Precision
Inch - Metric	Metric
Category	Thrust Ball Bearings
UNSPSC	31171507
Harmonized Tariff Code	8482.10.50.08
Noun	Bearing
Keyword String	Ball Thrust
Manufacturer URL	<a href="http://www.skf.com">http://www.skf.com</a>
Manufacturer Item Number	51104
Weight / LBS	0.095
Outside Diameter	1.378 Inch   35 Millimeter
Bore 2	0.827 Inch   21 Millimeter
Bore 1	0.787 Inch   20 Millimeter
Overall Height with Aligning Washer	0 Inch   0 Millimeter
Height	0.394 Inch   10 Millimeter
bore diameter:	20 mm
static load capacity:	29 kN
outside diameter:	35 mm



## NTNY BEARING LTD

dynamic load capacity:	15.1 kN
overall width:	10 mm
maximum rpm:	10000 RPM
thrust bearing type:	Single-Direction
cage material:	Steel
outside diameter design:	Straight
fillet radius:	0.3 mm
separable or banded:	Separable
series:	511
precision rating:	ABEC 1 (ISO Class Normal)
$d_1$	35 mm
$D_1$	21 mm
$r_{1,2}$ min.	0.3 mm
$d_a$ min.	29 mm
$D_a$ max.	26 mm
$r_a$ max.	0.3 mm
Basic dynamic load rating C	15.1 kN
Basic static load rating $C_0$	29 kN
Fatigue load limit $P_u$	1.08 kN
Minimum load factor A	0.0044
Mass bearing (including seat washer where applicable)	0.037 kg