

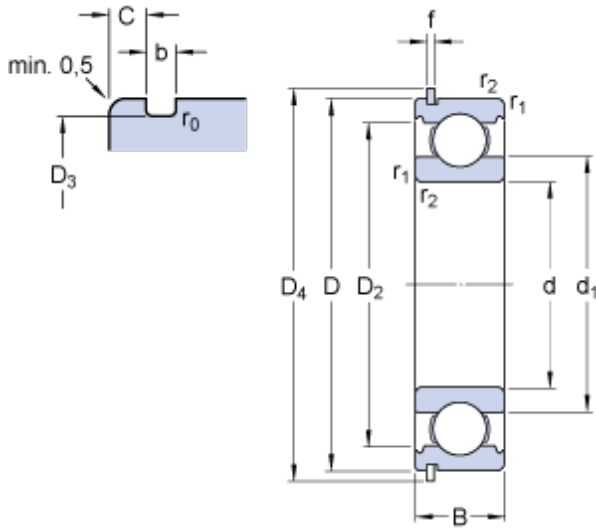

# NTNY BEARING LTD



## 25 mm x 52 mm x 15 mm skf 6205 nr bearing

Bearing No. 6205 nr

|   |             |
|---|-------------|
| Size                                      | 52x25x15 mm |
| Bore Diameter                             | 52 mm       |
| Outer Diameter                            | 25 mm       |
| Width                                     | 15 mm       |
| d   | 25 mm       |
| D   | 52 mm       |
| B   | 15 mm       |
| d <sub>1</sub>                            | 34.35 mm    |
| D <sub>2</sub>                            | 46.21 mm    |
| D <sub>3</sub>                            | 49.73 mm    |
| D <sub>4</sub>                            | 57.9 mm     |
| b   | 1.35 mm     |
| C   | 2.46 mm     |
| f   | 1.12 mm     |
| r <sub>0</sub>                            | 0.4 mm      |
| r <sub>1,2</sub> - min.                   | 1 mm        |
| d <sub>a</sub> - min.                     | 30.6 mm     |
| D <sub>a</sub> - max.                     | 46.4 mm     |
| D <sub>b</sub> - min.                     | 59 mm       |
| b <sub>a</sub> - min.                     | 1.5 mm      |
| C <sub>a</sub> - max.                     | 3.58 mm     |
| r <sub>a</sub> - max.                     | 1 mm        |
| Basic dynamic load rating - C             | 14.8 kN     |
| Basic static load rating - C <sub>0</sub> | 7.8 kN      |
| Fatigue load limit - P <sub>u</sub>       | 0.335 kN    |

6205 nr Bearing 2D drawings and 3D CAD models



## NTNY BEARING LTD

|                                 |  |
|---------------------------------|--|
| Reference speed                 | 28000 r/min  |
| Limiting speed                  | 18000 r/min  |
| Calculation factor - $k_r$      | 0.025  |
| Calculation factor - $f_0$      | 14   |
| Mass bearing                    | 0.13 kg  |
| Category                        | Single Row Ball Bearings   |
| Inventory                       | 0.0  |
| Manufacturer Name               | SKF  |
| Minimum Buy Quantity            | N/A  |
| Weight / Kilogram               | 0.137  |
| EAN                             | 7316577096616  |
| Product Group                   | B00308   |
| Enclosure                       | Open   |
| Precision Class                 | ABEC 1   ISO P0  |
| Maximum Capacity / Filling Slot | No   |
| Rolling Element                 | Ball Bearing   |
| Snap Ring                       | Yes  |
| Internal Special Features       | No   |
| Cage Material                   | Steel  |
| Internal Clearance              | C0-Medium  |
| Inch - Metric                   | Metric   |
| Long Description                | 25MM Bore; 52MM Outside Diameter; 15MM Outer Race Width; Open; Ball Bearing; ABEC 1   ISO P0; No Filling Slot; Yes Snap Ring; No Internal Special Features; C0-Medium Internal Clearance; Steel Cage |
| Other Features                  | Deep Groove   With Snap Ring   |
| Category                        | Single Row Ball Bearing  |
| UNSPSC                          | 31171504   |



## NTNY BEARING LTD

|                                |   |
|--------------------------------|---|
| Harmonized Tariff Code         | 8482.10.50.68                                       |
| Noun                           | Bearing   |
| Keyword String                 | Ball  |
| Manufacturer URL               | <a href="http://www.skf.com">http://www.skf.com</a> |
| Manufacturer Item Number       | 6205 NR   |
| Weight / LBS                   | 0.302   |
| Bore                           | 0.984 Inch   25 Millimeter                          |
| Outer Race Width               | 0.591 Inch   15 Millimeter                          |
| Inner Race Width               | 0 Inch   0 Millimeter                               |
| Outside Diameter               | 2.047 Inch   52 Millimeter                          |
| $d_1$                          | 34.35 mm  |
| $D_2$                          | 46.21 mm  |
| $D_3$                          | 49.73 mm  |
| $D_4$                          | 57.9 mm   |
| $r_0$ max.                     | 0.4 mm  |
| $d_a$ min.                     | 30.6 mm   |
| $D_a$ max.                     | 46.4 mm   |
| $D_b$ min.                     | 59 mm   |
| $b_a$ min.                     | 1.5 mm  |
| $C_a$ max.                     | 3.58 mm   |
| $r_a$ max.                     | 1 mm  |
| Basic dynamic load rating C    | 14.8 kN   |
| Basic static load rating $C_0$ | 7.8 kN  |
| Fatigue load limit $P_u$       | 0.335 kN  |
| Calculation factor $k_r$       | 0.025   |
| Calculation factor $f_0$       | 14  |
| Snap ring                      | SP 52   |