

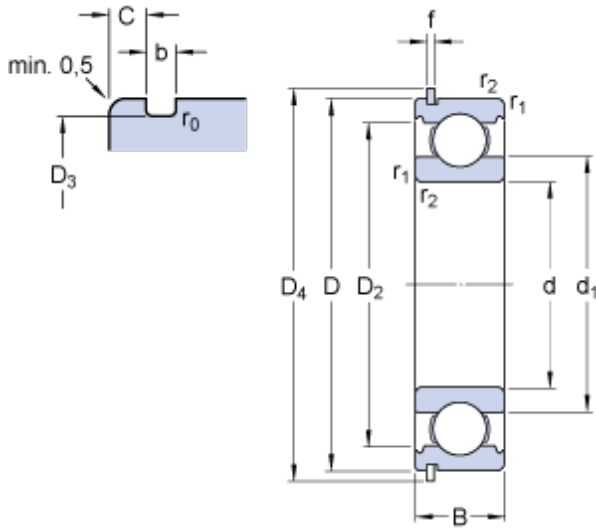

# NTNY BEARING LTD



30 mm x 62 mm x 16 mm skf 6206 nr bearing

Bearing No. 6206 nr

Size	62x30x16 mm
Bore Diameter	62 mm
Outer Diameter	30 mm
Width	16 mm
d	30 mm
D	62 mm
B	16 mm
d <sub>1</sub>	40.36 mm
D <sub>2</sub>	54.06 mm
D <sub>3</sub>	59.61 mm
D <sub>4</sub>	67.7 mm
b	1.9 mm
C	3.28 mm
f	1.7 mm
r <sub>0</sub>	0.6 mm
r <sub>1,2</sub> - min.	1 mm
d <sub>a</sub> - min.	35.6 mm
D <sub>a</sub> - max.	56.4 mm
D <sub>b</sub> - min.	69 mm
b <sub>a</sub> - min.	2.2 mm
C <sub>a</sub> - max.	4.98 mm
r <sub>a</sub> - max.	1 mm
Basic dynamic load rating - C	20.3 kN
Basic static load rating - C <sub>0</sub>	11.2 kN
Fatigue load limit - P <sub>u</sub>	0.475 kN

6206 nr Bearing 2D drawings and 3D CAD models



## NTNY BEARING LTD

Reference speed	24000 r/min
Limiting speed	15000 r/min
Calculation factor - $k_r$	0.025
Calculation factor - $f_0$	13.8
Mass bearing	0.205 kg
Category	Single Row Ball Bearings
Inventory	0.0
Manufacturer Name	SKF
Minimum Buy Quantity	N/A
Weight / Kilogram	0.21
EAN	7316577741073
Product Group	B00308
Enclosure	Open
Precision Class	ABEC 1   ISO P0
Maximum Capacity / Filling Slot	No
Rolling Element	Ball Bearing
Snap Ring	Yes
Internal Special Features	No
Cage Material	Steel
Internal Clearance	C0-Medium
Inch - Metric	Metric
Long Description	30MM Bore; 62MM Outside Diameter; 16MM Outer Race Width; Open; Ball Bearing; ABEC 1   ISO P0; No Filling Slot; Yes Snap Ring; No Internal Special Features; C0-Medium Internal Clearance; Steel Cage
Other Features	Deep Groove   With Snap Ring
Category	Single Row Ball Bearing
UNSPSC	31171504



## NTNY BEARING LTD

Harmonized Tariff Code	8482.10.50.68
Noun	Bearing
Keyword String	Ball
Manufacturer URL	<a href="http://www.skf.com">http://www.skf.com</a>
Manufacturer Item Number	6206 NR
Weight / LBS	0.439
Outer Race Width	0.63 Inch   16 Millimeter
Inner Race Width	0 Inch   0 Millimeter
Outside Diameter	2.441 Inch   62 Millimeter
Bore	1.181 Inch   30 Millimeter
$d_1$	40.36 mm
$D_2$	54.06 mm
$D_3$	59.61 mm
$D_4$	67.7 mm
$r_0$ max.	0.6 mm
$r_{1,2}$ min.	1 mm
$d_a$ min.	35.6 mm
$D_a$ max.	56.4 mm
$D_b$ min.	69 mm
$b_a$ min.	2.2 mm
$C_a$ max.	4.98 mm
$r_a$ max.	1 mm
Basic dynamic load rating C	20.3 kN
Basic static load rating $C_0$	11.2 kN
Fatigue load limit $P_u$	0.475 kN
Calculation factor $k_r$	0.025
Calculation factor $f_0$	13.8
Snap ring	SP 62